

Cuisinart®

INSTRUCTION BOOKLET



Professional Food Slicer

CFS-155C

For your safety and continued enjoyment of this product,
always read the instruction book carefully before using.

IMPORTANT SAFEGUARDS

When using electrical appliances, basic safety precautions should always be followed including the following:

1. **READ ALL INSTRUCTIONS.**
2. **Unplug from outlet when not in use, before putting on or taking off parts, and before cleaning. This appliance is not recommended for use by children.**
3. **BLADE IS EXCEPTIONALLY SHARP. HANDLE VERY CAREFULLY.**
4. To protect against risk of electrical shock, do not put appliance in water or other liquid.
5. Close supervision is necessary when any appliance is used by or near children.
6. Avoid contacting with moving parts.
7. Never put the unit near a hot burner, in an oven, or in a dishwasher.
8. Do not operate the Cuisinart® Food Slicer, or any other electrical equipment, with a damaged cord or plug or after the unit malfunctions or is dropped or damaged in any manner.
9. Do not use outdoors.
10. Do not let cord hang over edge of a table or counter, contact sharp edges, or touch hot surfaces.
11. Do not pull on the power cord to disconnect.
12. Never plug in the appliance where water may flood the area.
13. Place the appliance on a firm and stable surface.
14. **NEVER PUT YOUR FINGERS NEAR THE BLADE WHILE IT IS IN OPERATION.**
15. Ensure that the appliance is not placed close to the edge of the table, worktop, etc. where it can be pushed off or fall.
16. The use of attachments not recommended or sold by the manufacturer may cause fire, electric shock or injury.
17. Never use abrasive cleaning agents or abrasive cloths when cleaning the unit.
18. The Cuisinart® Food Slicer has a **sharp blade. To avoid injury, never hand-feed food to be sliced.** Always use the unit when completely assembled with food carriage and food press.
19. This appliance has a polarized plug (one blade is wider than the other). To reduce the risk of electric shock, this plug will fit in a polarized outlet only one way. If the plug does not fit the outlet perfectly, reverse the plug. If it still does not fit, contact a qualified electrician. Do not modify the plug in any way.
20. Do not leave the Cuisinart® Food Slicer unattended while it is running.
21. Always place hand on Food Guide Handles when slicing. (Refer to Figure: CORRECT HANDLING METHOD).
22. Never place hand behind food carriage.
23. Do not use this Food Slicer without Food Guide Handles.
24. To avoid injury, never use hand to push food when slicing.
25. Unplug before cleaning.
26. Do not use appliance for other than intended use.

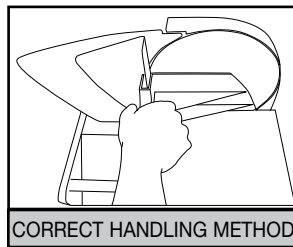

SAVE THESE INSTRUCTIONS FOR HOUSEHOLD USE ONLY

TO REMOVE BLADE GUARD

1. Peel off caution label at the corner.
2. Turn the thickness adjustable knob to maximum position.
3. Remove the rubber blade guard.
4. Turn the thickness adjustable knob to minimum position.

IMPORTANT UNPACKING INSTRUCTIONS

CAUTION:THE SLICING BLADE HAS A VERY SHARP EDGE.

To avoid injury when unpacking the unit, please follow these instructions:

1. Place the box on a large, sturdy, flat surface.
2. Remove the instruction book and any other literature.
3. Place box on its side. Slide the packaged unit out of the box.
4. Remove the Styrofoam® inserts.
5. Carefully remove the Cuisinart® Food Slicer from the plastic bag. Please use extreme caution in removing the rubber guards from slicing blade area. We suggest you save all the packing materials in the event that future shipping of the machine is needed. Keep all plastic bags away from children.

REPACKING INSTRUCTIONS

1. Place food slicer on a large, sturdy flat surface.
2. Place food slicer into plastic bag.
3. Place Styrofoam® inserts on each end of food slicer.
4. Place the packaged unit into the upright box.
5. Replace top corrugation, instruction book and other literature.

TABLE OF CONTENTS

Important Safeguards.....	2
Unpacking Instructions	2
Introduction	3
Parts List	4
Use and Care	4
Cleaning Instructions.....	5
Important Facts You Should Know About Your Cuisinart®	
Food Slicer	5
Tips.....	5
Warranty	6

INTRODUCTION

ANY WAY YOU SLICE IT!

The Cuisinart® Food Slicer eliminates one of the most time-consuming jobs in food prep. This commercial-quality slicer adjusts from 5mm to 15mm to let you slice everything from paper-thin pepperoni to perfect servings of roast beef. It makes life a little more fun, and entertaining as easy as 1-2-3!

PARTS

- | | |
|----------------------------------------------------|-----------------------------------------------|
| 1. ON-OFF Switch | 5. Food Guide |
| 2. Slice Control Knob | 6. Plastic Safety Guard |
| 3. Non-Slip Feet | 7. Removable Stainless Steel Slicing Carriage |
| 4. 7.5" (18.75 cm) Undulated Stainless Steel Blade | 8. Center hub for blade removal |

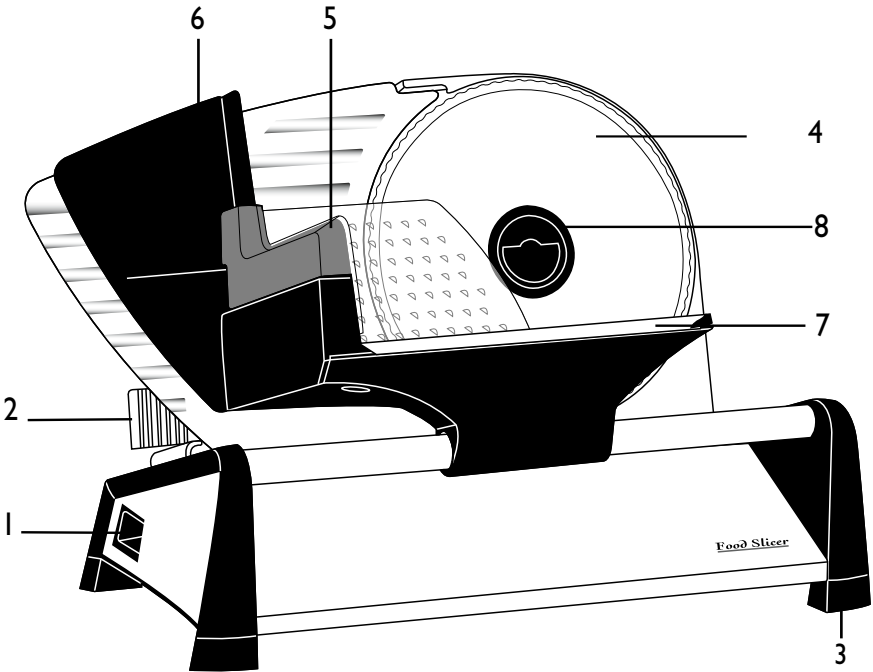

USE AND CARE

1. To use your Cuisinart® Food Slicer, place on sturdy, flat surface.
2. Check that the switch is turned OFF before plugging in the appliance.
3. Adjust the slice control knob to desired slicing thickness [5mm to 15mm].
4. Place food to be cut on the stainless steel carriage and secure with plastic safety guard.
5. Turn the Cuisinart® Food Slicer ON.
6. Place hands on food guide handles and smoothly slide carriage backward and forward. NEVER USE YOUR FINGERS.
7. To ensure perfect slicing, do not press the food against the blade too firmly.
8. At this point, check for desired thickness and adjust accordingly with the Slice Control Knob.
9. Continue to slide food carriage back and forth in an even and steady motion.
10. After all your slicing is done, turn the slicer OFF and unplug.

The Cuisinart® Food Slicer has been designed to operate for short periods (max. 10 min.). If the power cord is damaged, a service centre recommended by the manufacturer must repair it.

CLEANING & MAINTENANCE

Always unplug your Cuisinart® Food Slicer and turn the slice control knob back to zero, before cleaning the appliance. DO NOT PUT THE APPLIANCE IN WATER. This could cause damage to electrical parts.

1. Clean and dry parts immediately after use.
2. Fold out food carriage away from the base for easy cleaning of crumbs, seeds, etc.
3. To remove food carriage for cleaning, hold food carriage with two hands and tilt frontward towards you. There is a button to release the carriage marked "Press to release." Press, release, and wash with warm soapy water. Dry thoroughly. To reassemble, align top part of food carriage to bottom part of food carriage and click into place.
4. To remove blade, press in tab where indicated in center hub; twist clockwise and carefully lift and remove blade.
5. With a soft sponge or cleaning cloth, clean both sides of blade with mild soap and water. Rinse and dry blade thoroughly.
6. To replace blade, hold tab, aligning the blade with the drive gears so it engages fully. Turn tab counterclockwise to tighten.
7. Any other servicing should be performed by an authorized service representative.

DO NOT WASH ANY PART OF SLICER IN DISHWASHER.

TIPS FOR USING YOUR CUISINART® FOOD SLICER

The Cuisinart® Food Slicer does a great job on a variety of foods. Throwing a great dinner party is as easy as 1-2-3. Start with an easy and delicious antipasto appetizer of sliced cheese, salami and French bread. For best results, always use a hard cheese which has been refrigerated. Slicing the salami and then the French bread will allow for an easier cleanup. Then, move on to slice salad ingredients, potatoes for potatoes au gratin, and even roast beef.

Homemade apple pie can be fast and delicious when the Cuisinart® Food Slicer does all the slicing work for you.

A child's birthday party can be fun and easy. Just slice all your ingredients for pizza in advance, and the children can have a great time making their own pizzas.

Having a summer barbecue is effortless with the Cuisinart® Food Slicer. Tomatoes, onions, cheese and even lettuce take no time at all to prepare.

For all your slicing needs, from paper-thin to extra-thick, the Cuisinart® Food Slicer makes food preparation fast and easy.

WARRANTY

LIMITED THREE-YEAR

WARRANTY

We warrant that this Cuisinart product will be free of defects in materials or workmanship under normal home use for 3 years from the date of original purchase. This warranty covers manufacturer's defects including mechanical and electrical defects. It does not cover damage from consumer abuse, unauthorized repairs or modifications, theft, misuse, or damage due to transportation or environmental conditions. Products with removed or altered identification numbers will not be covered.

This warranty is not available to retailers or other commercial purchasers or owners. If your Cuisinart product should prove to be defective within the warranty period, we will repair it or replace it if necessary. For warranty purposes, please register your product online at www.cuisinart.ca to facilitate verification of the date of original purchase and keep your original receipt for the duration of the limited warranty. This warranty excludes damage caused by accident, misuse or abuse, including damage caused by overheating, and it does not apply to scratches, stains, discolouration or other damage to external or internal surfaces that does not impair the functional utility of the product. This warranty also expressly excludes all incidental or consequential damages.

Your Cuisinart product has been manufactured to the strictest specifications and has been designed for use only in 120 volt outlets and only with authorized accessories and replacement parts. This warranty expressly excludes any defects or damages caused by attempted use of this unit with a converter, as well as use with accessories, replacement parts or repair service other than those authorized by Cuisinart.

If the appliance should become defective within the warranty period, do not return the appliance to the store. Please contact our Customer Service Centre:

Toll-free phone number:

1-800-472-7606

Address:

Cuisinart Canada

100 Conair Parkway

Woodbridge, Ont. L4H 0L2

Email: consumer_Canada@conair.com

Model: CFS-155C

To facilitate the speed and accuracy of your return, please enclose:

- \$10.00 for shipping and handling of the product (cheque or money order)
 - Return address and phone number
 - Description of the product defect
 - Product date code*/copy of original proof of purchase
 - Any other information pertinent to the product's return
- * Product date code can be found on the underside of the base of the product.

The product date code is a 4 or 5 digit number. Example, 90630 would designate year, month & day (2009, June 30th).

Note: We recommend you use a traceable, insured delivery service for added protection.

Cuisinart will not be held responsible for in-transit damage or for packages that are not delivered to us. To order replacement parts or accessories, call our Customer Service Centre at 1-800-472-7606.

For more information, please visit our website at www.cuisinart.ca

Cuisinart™

SAVOR THE GOOD LIFE®



Coffeemakers



Food
Processors



Toasters



Rice Cookers



Grills

Cuisinart offers an extensive assortment of top quality products to make life in the kitchen easier than ever. Try some of our other countertop appliances and cookware, and Savor the Good Life®.

www.cuisinart.ca

©2012 Cuisinart

100 Conair Parkway
Woodbridge, Ontario L4H 0L2

Visit our Website:

www.cuisinart.ca

Consumer Call Centre E-mail:

Consumer_Canada@Conair.com

Printed in China

11CC128067

Any trademarks or service mark of third parties used herein are the trademarks or service marks of their respective owners.

IB-10734-CAN